



Name :
Roll No. :
Invigilator's Signature :

CS/B.Arch/SEM-2/ARCH-205/2013

2013

ARCHITECTURAL GRAPHICS – II

Time Allotted : 3 Hours

Full Marks : 70

The figures in the margin indicate full marks.

Candidates are required to give their answers in their own words as far as practicable.

Answer any *two* questions.

1. A rectangle 6 cm × 4 cm is superimposed on a square 5 cm × 5 cm so that their centres coincide, to form a composite bloc. The block has a height of 6 cm.
 - a) Draw an isometric view of the block. 10
 - b) Draw a 2-point perspective view with the station point 7.5 cm away from the object and picture plane touching the object and the ground line being 2.5 cm below the horizon. 25
- 2.

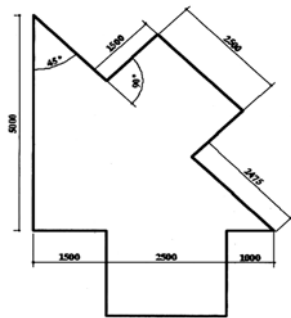

MEASUREMENTS ARE IN MILLIMETRES

- a) Draw an isometric view of the block (height 8cm) shown. 10

2224

[Turn over

CS/B.Arch/SEM-2/ARCH-205/2013



- b) Draw a 2-point perspective view with the station point 3 cm away from the object and picture plane touching the object at the furthest vertex of the triangle and the ground line being 6 cm below the horizon. 25

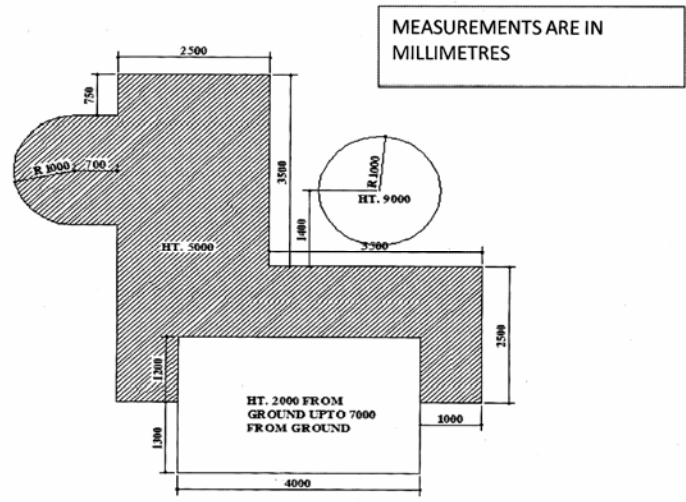

- 3. The figure above is a top view of a combined block of masses. Draw proper elevations of all four sides and mark shades and shadows indicating a sun angle. 35
- 4. Draw a proper birds' eye view of the figure given in Question No. 3 so that all masses and their interrelationship are visible. 35

